

TABLE OF CONTENTS

X-ARCADE™ TRACKBALL OVERVIEW	3
SETUP - CONNECTING TO A PC	4
OPERATION WITH A PC	5
SETUP - CONNECTING TO A MAC™	6
OPERATION WITH A MAC™	7
GOLF GAMES	8
OPERATION WITH MAME™	9
OPERATION WITH GAME CONSOLES	10
TROUBLESHOOTING	12
CLEANING INSTRUCTIONS	14
WARRANTY	16

THANK YOU FOR YOUR PURCHASE

The XGAMING® Inc. team is excited to bring the X-Arcade™ Trackball mouse into your home. With your X-Arcade™ Trackball, reverse time and play the classics like Centipede™, Marble Madness™, Golden Tee Golf™ and any of your favorite titles which can be controlled with a mouse! For golf fans, inject arcade-style play into EA Sports™ Tiger Woods PGA Tour™ with the most authentic input device available.

We thank you for your purchase and welcome you to the X-Arcade™ family!

IMPORTANT – READ BEFORE INSTALLATION

- The X-Arcade™ Trackball works out of the box with a Personal Computer, Mac™, or Playstation 2™ (with supported games). No special drivers are needed.
- The X-Arcade™ Trackball plugs into a standard PS/2 mouse port or USB port on a PC or Mac™. (PS/2 refers to a PC connection, not Playstation 2™)
- Be sure to turn off the computer before plugging or unplugging the X-Arcade™ Trackball from the PS/2 mouse port.
- Using with emulation software, be sure to enable mouse support.
If you need help with using your X-Arcade™ Trackball with certain software or games, be sure to visit the "Customer Service" and "Arcade Center" sections of our website – www.X-Arcade.com
- The X-Arcade™ Trackball acts like a MOUSE and works on any game or application as a mouse. It will therefore not show up as a game controller on a PC/Mac™.
- 3rd-party mouse drivers/software can effect the performance of the X-Arcade™ Trackball. If this is your case, disable them when using the trackball if possible.
- The speed and sensitivity of the trackball can be adjusted in the operating system as a mouse, but for the most part you will want to simply make adjustments in the game or emulator's settings.
- **DO NOT** clean with any ammonia based products such as Windex.

X-ARCADE TRACKBALL OVERVIEW

Included in this Kit:

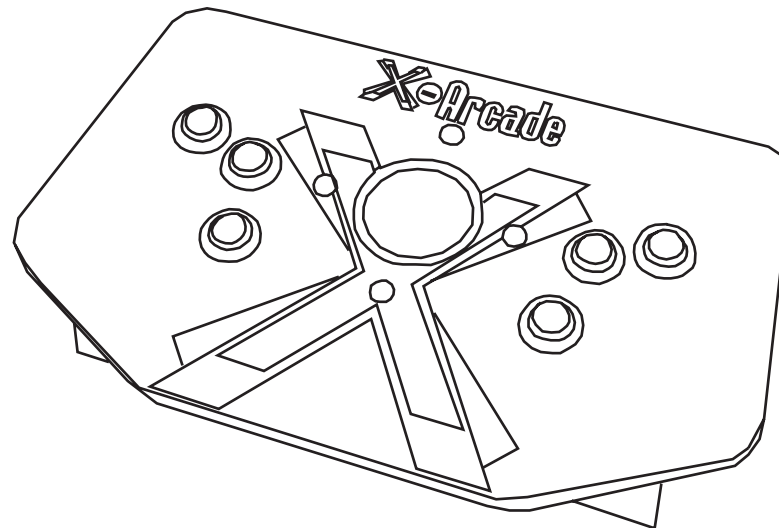

FEATURES

- Industrial Grade Arcade Parts
- Dual Button Layout For Left Or Right Handed Players
- Authentic Arcade-Style Pinball Buttons
- PS/2 and USB Port Connections
- 10 FT Long Cable
- Works As Standard 3 Button Mouse, Compatible With Any Mouse Based Game
- Horizontal Disabler Button
- Full Version Arcade Games Included
- Indestructible Arcade Design - Built Like A Friggin' Tank!

CONNECTING TO A PC

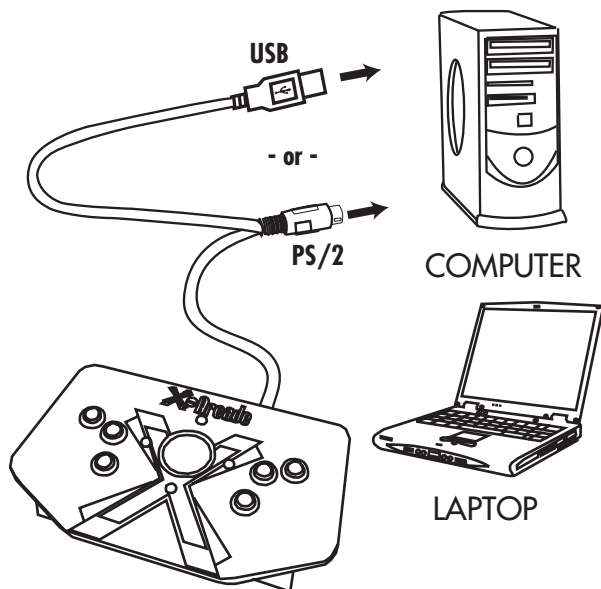

NOTE: Optionally connect to a PC via either the PS/2 keyboard port or a USB port, **YOU DO NOT NEED TO CONNECT BOTH!**



PS/2 MOUSE PORT CONNECTION

- 1) Turn off your computer! Always turn off your computer before connecting or disconnecting any non-USB hardware.
- 2) Unplug any PS/2 mouse from the back of your computer (if you have one).
- 3) Plug the X-Arcade™ Trackball's cable into the round PS/2 mouse port on the back of your computer. The PS/2 port is most often green in color.
- 4) Optionally connect another USB mouse while your X-Arcade™ Trackball is connected to PS/2 Port.



USB PORT CONNECTION

- 1) Plug the X-Arcade™ Trackball into any USB port on your PC or USB hub.
- 2) You can connect any other PS/2 or USB mouse into the PC as well.

OPERATION WITH A PC

On a *PC*, the buttons are assigned to specific mouse buttons. When you press a button on the X-Arcade™ Trackball, your computer thinks you are pressing a button on your mouse. You can also adjust your mouse speed in your operating system to adjust the speed of the X-Arcade™ Trackball.

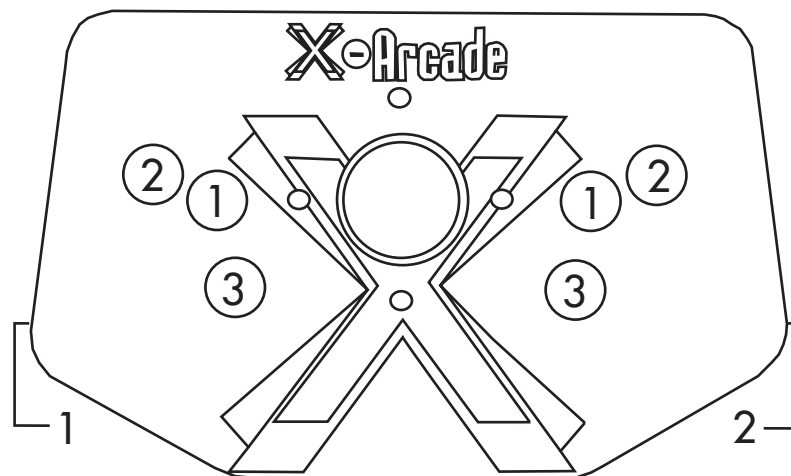

The numbered buttons in this diagram represent the mouse buttons they correspond to.

For most games on your computer, you will need to change the button assignment to the actions or functions you wish them to perform within the game itself.

The first time you play a game, you must go to the game's options menu. Most likely it will be **SETUP**, **SETUP CONTROLS**, **OPTIONS**, or **CONTROLS** that leads you to the menu for assigning actions in games. The majority of Windows™ based games require that you first start the game, and then press either **ESC** or go to the main menu where there will be an icon that represents the **OPTIONS** for the game or the **CONTROLS** for the game.

Once you find the game's **OPTIONS**, and subsequently, the game's **CONTROLS**, you must understand how to change the game's pre-programmed default keys to the keys on the X-Arcade™ Trackball. Make sure the controls in the game are set to **MOUSE**, **NOT A KEYBOARD OR JOYSTICK**, as the X-Arcade™ Trackball is seen as a mouse by your PC and games.

CONNECTING TO A MAC™

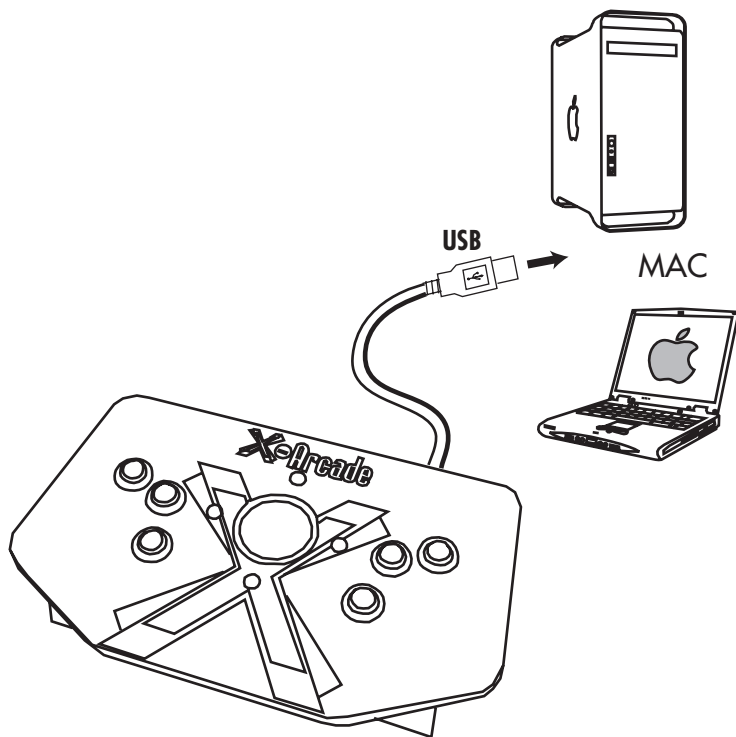

USB PORT CONNECTION

- 1) Plug the X-Arcade™ Trackball into any USB port on your Mac™ or a USB hub.
- 2) You can also connect any USB Mouse to your Mac™ while your X-Arcade™ Trackball is connected.

OPERATION WITH A MAC™

On a Mac™, the buttons are assigned to specific mouse buttons. When you press a button on the X-Arcade™ Trackball, your Mac™ thinks you are pressing a button on your mouse. You can also adjust your mouse speed in your operating system to adjust the speed of the X-Arcade™ Trackball.

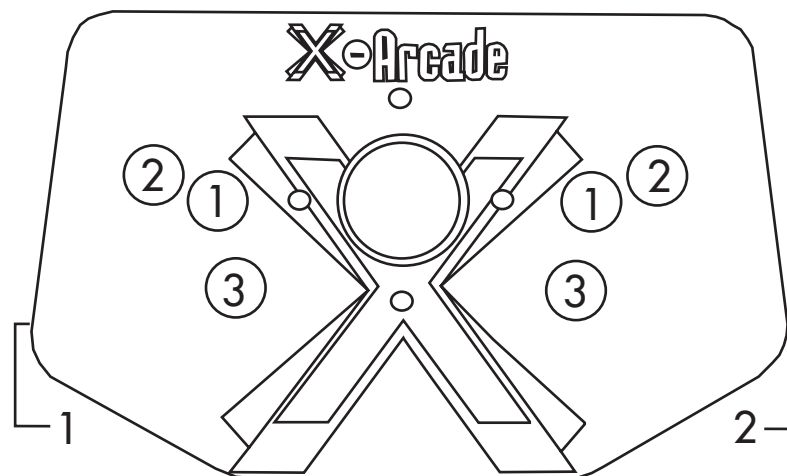

The numbered buttons in this diagram represent the mouse buttons they correspond to.

For most games on your Mac™, you will need to change the button assignment to the actions or functions you wish them to perform within the game itself.

The first time you play a game, you must go to the game's options menu. Most likely it will be **SETUP**, **SETUP CONTROLS**, **OPTIONS**, or **CONTROLS**. and lead you to the menu for assigning actions in games. The majority of Mac™ games require that you first start the game, and then press either **ESC** or go to the main menu, where there will be an icon that represents the **OPTIONS** for the game or the **CONTROLS** for the game.

Once you find the game's **OPTIONS**, and subsequently, the game's **CONTROLS**, you must understand how to change the game's pre-programmed default keys to the keys on the X-Arcade™ Trackball. Make sure the controls in the game are set to **MOUSE**, **NOT A KEYBOARD OR JOYSTICK**, as the X-Arcade™ Trackball is seen as a mouse by your Mac™ and games.

GOLF GAMES

Using X-Arcade™ Trackball With Golf Games:

You must learn the feel of the trackball, spend a few games just playing with different degrees of hook and slice. See what your shot does when you pull the trackball down-right and hit towards straight up. Then try it again pulling down-right but swinging it towards up-right. Notice where the shot ended up, and the flight path of the ball. The flight path is especially important because when you are trying to hit shortcuts, you must know exactly how that ball is going to travel to get to the green. Try the different degrees of movement. (shots that are aimed off center and have no hook or slice) During experimental games, hit the ball in the sand on purpose to practice chipping. Give yourself long putts to try and hit. If you always "palm" the ball, it is nearly impossible to hit precision shots, so use your thumbs for short shots. If you can, play online against better players. Most avid players are willing to teach if you just ask questions.

How to Swing Woods and Irons

- To achieve a full backswing, simply roll the trackball back underneath your palm or with your thumbs until the on-screen character is fully coiled.
 - Spin the trackball forward with some force* using your palm or thumbs to swing
- * Excessive force is not necessary or recommended as the game limits maximum distance.

How to Putt

- Roll the trackball back to move the on-screen character's putter fully back
- Aim for the hole and account for the green's break which is displayed on the overhead map. Aim slightly left for right-breaking putts and slightly right for left-breaking putts.
- Roll trackball forward with your thumbs or palm to putt the ball.

How to Chip

Just like in real golf, players have the ability to chip with any club in the bag

- Slowly roll the trackball back and draw the golfer's club to the desired height. (Traditionally, a waist-level backswing will suffice)
- In a smooth motion, roll the trackball forward to execute your chip.

OPERATION WITH MAME™

The X-Arcade™ Trackball has been optimized for use with arcade-style video games and has a preset configuration for the highly popular MAME™ arcade emulator on PC/Mac™. MAME™ is a software application that allows you to play arcade games on your computer. With MAME™, classic video games from the 70's and 80's are still alive and kicking today. These games are not remakes, but the original, authentic classic arcade games you played in the 70's, 80's and 90's.

Check out the "Arcade Gaming" section of www.X-Arcade.com for more info on MAME™.

Warning! MAME™ is an emulator. It reproduces, more or less faithfully, the behavior of various arcade machines. But hardware is useless without software, so images (files) of the ROMs which run on that hardware are required. Such ROMs, like all commercial software, are copyrighted.

NOTE: Before attempting to use the X-Arcade™ Trackball in MAME™, first be sure the X-Arcade™ Trackball is working as a mouse on your PC/Mac™. If it is not moving your mouse cursor, then it will not work in MAME™. Also be sure you are using the newest version of MAME™. Links to download it can be found on the "Customer Service" section of our website at www.X-Arcade.com.

You then need to enable mouse support in your version of MAME™:

MAME™32 SETUP

- 1) In MAME™32 choose the "Options" menu (at the top), and click "Default Game Option"s from the drop-down menu.
- 2) Select the "Game Controllers" tab.
- 3) Click the box next to "Enable Mouse Support" to add a check mark (if it is not already checked).

All of your trackball based MAME™ games will work with that configuration.

MAME™ GAMEPLAY

When you are in a game, you can change the button configuration and adjust the sensitivity of movement by pressing the "TAB" key to bring up the options menu.

To adjust sensitivity, go to "Analog Controls" and change the "Track X Sensitivity" and "Track Y Sensitivity" percentage to adjust the ball speed to what feels best for you in each game. If you roll the ball fast and find that you get backlash, you have the sensitivity set too high.

More info on this can be found at the "Customer Service" section of www.X-Arcade.com

OPERATION WITH GAME CONSOLE

It is possible to plug the X-Arcade™ Trackball into game consoles that have native mouse support. Keep in mind though that not all console games support the use of a mouse, so be sure that the game you wish to play has mouse support. Some games you will also want to use a keyboard and/or gampad to play along with the X-Arcade™ Trackball for full control. Check out the "Customer Service" section of www.X-Arcade.com for a list of console games with mouse support.

Playstation 2™:

The Playstation 2™ has 2 USB ports on the front.

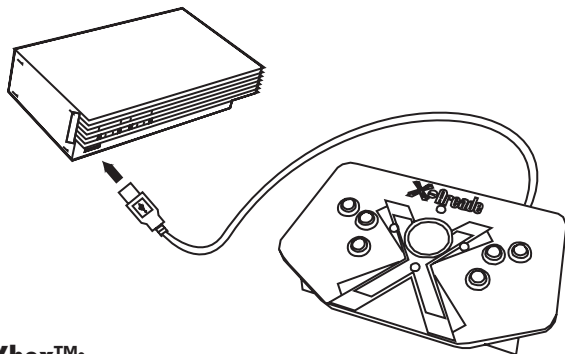

Xbox™:

The Xbox™ currently does not have direct mouse support, nor do current Xbox™ games. You can however purchase a USB-Xbox™ adapter which will allow you to use the trackball on programs and emulators that make use of mouse control.

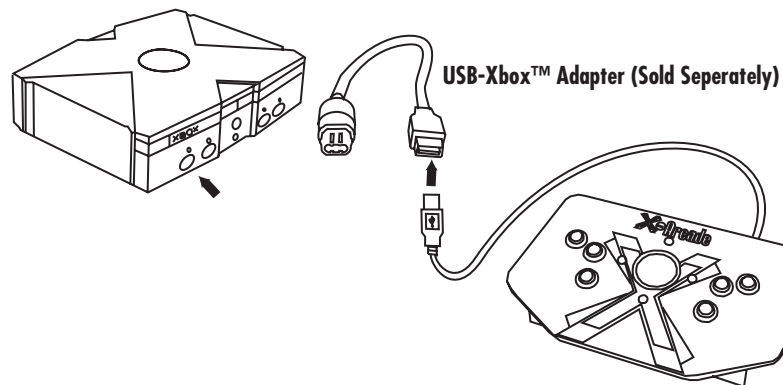

Mouse to Console Adapters:

The X-Arcade™ Trackball has also been tested with mouse-to-console adapters. Some games you will also want to use a keyboard along with the X-Arcade™ Trackball for full control.

See the "Customer Service" section of www.X-Arcade.com for more info on this.

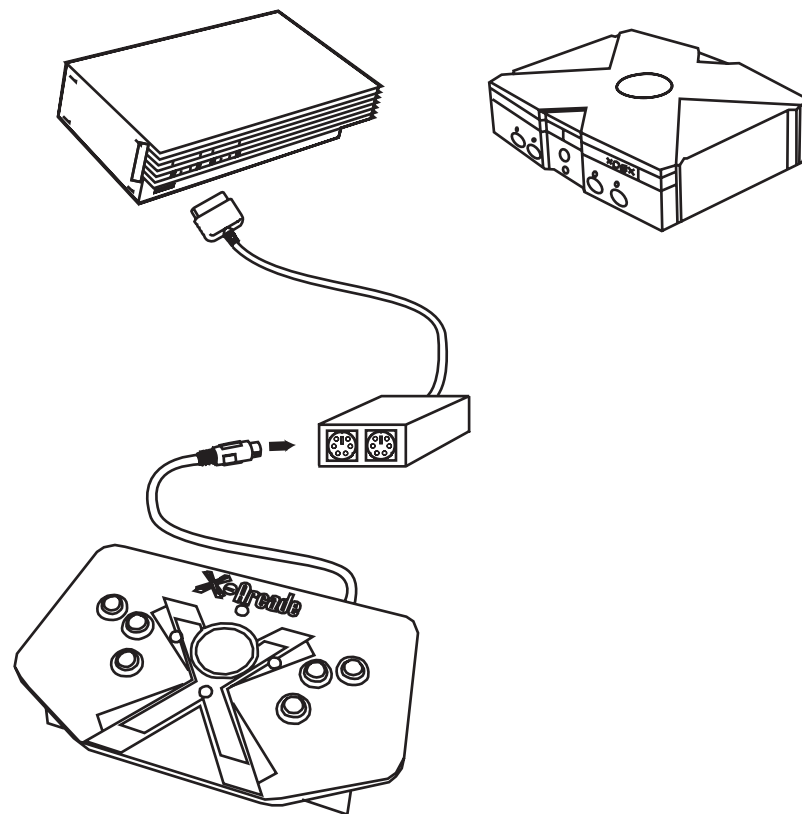

TROUBLESHOOTING

Please refer to the "Customer Service" and "Technical Support" section at www.x-arcade.com for more in depth help, frequently updated support answers, as well as Live Chat .

Toll Free Technical Support is available at 1-866-942-6464 (M-F 9-5 Eastern Time)

Here are some suggestions if you are experiencing problems:

- Make sure all of your connections are tight and secure.
- Any time you connect or disconnect anything to/from a PS/2 port, **TURN OFF THE COMPUTER!**
- PS/2 Connection: Make sure your X-Arcade™ Trackball's cable is plugged into the computer's **PS/2 MOUSE PORT** (not keyboard port). The mouse port is usually green in color.
- If you can't get the X-Arcade™ Trackball to function on your computer, try it on another computer to verify the unit is working properly. If it does work on a different computer, you may simply need to remove some other mouse drivers from the initial computer.
- When playing with MAME™ or emulation software, you must enable mouse support in the emulator's options menu. See page 9 of this manual for more info on this.
- Playing with MAME™ you can change the sensitivity of the X-Arcade™ Trackball movements by hitting the "TAB" key on your keyboard while a game is running, and under "Analog Controls" menu change the X and Y Sensitivity percentage. (higher % is more sensitive). If you roll the ball fast and get kickback, you have the sensitivity set too high. More info on this can be found on page 9 of this manual.

HOW CAN I USE MORE THAN 1 X-ARCADE™ TRACKBALL ON MY PC OR MAC™?

For a dual trackball game (such as Marble Madness™), you can use the DOS Version of standard MAME™, or get a special Win32 MAME™ build that supports two USB trackballs. More info on this can be found on the "Customer Service" and "Technical Support" sections of www.X-Arcade.com

HOW CAN I MAKE MY X-ARCADE™ TRACKBALL MOVE FASTER OR SLOWER (MORE/LESS SENSITIVE) ON MY PC?

Go to the "Mouse" section of your Control Panel in Windows™, under the "Pointer Options" tab adjust the "Select Pointer Speed" bar to faster for more sensitive movement, less for slower movement. This menu may be slightly different if you have 3rd party mouse software installed. Remember that this

adjustment will also effect any other mouse you may have connected.

MY X-ARCADE™ TRACKBALL MOVES ERRATICALLY OR STICKS, WHAT CAN I DO?

Your X-Arcade™ Trackball may need cleaned. See page 14 of this manual for details.

MY X-ARCADE™ TRACKBALL WON'T MOVE LEFT OR RIGHT, WHAT'S GOING ON?

The button on the back of the X-Arcade™ Trackball disables left and right movement when it is pressed, be sure you are not holding it against something when you are playing.

MY X-ARCADE™ TRACKBALL WON'T MOVE MY CHARACTER IN MY GAME, WHAT GIVES?

Be sure that the game you are trying to play has mouse support. Also be sure to enable mouse control in the game, and assign the buttons and movement as desired.

A BUTTON IS NOT WORKING, WHAT CAN I DO?

- 1) Check to see if the X-Arcade™ Trackball itself is working as a mouse outside of a game. If it is not, first check that your connections are securely plugged in.
- 2) If the X-Arcade™ Trackball responds including all of the buttons outside of a game, then you may simply need to configure it properly for the game/emulator you are trying to use it with.
- 3) If a button is still not responding:
 - Open the X-Arcade™ Trackball using the instructions on page 14, and check to be sure that the microswitch is firmly seated in the button's socket. If it is not, simply snap it snugly back into place.
 - Be sure that there is nothing, for instance a wire, in between the microswitch and the button causing them not to connect properly.
 - Check that the wires are firmly attached to the microswitch.

CAN I USE AN X-ARCADE™ CONTROLLER WITH THE X-ARCADE™ TRACKBALL?

Yes! The X-Arcade™ simply acts as a keyboard, and the X-Arcade™ Trackball as your mouse.

CLEANING YOUR X-ARCADE™ TRACKBALL

Input devices using mouse or track ball technology need to be cleaned periodically. Cleaning frequency for your X-Arcade™ Trackball is much less than a normal trackball or mouse due to its design, but this depends on how you work with it, and can be affected adversely by spilling liquids on the ball or using it with sticky/dirty fingers. When moving the ball of the trackball feels slow or rough, it's time for a cleaning.

To clean your X-Arcade™ Trackball:

NOTE: Do not open the plastic trackball housing upside-down (ball facing down) as this will cause all of the parts to fall out.

1. Turn off your computer if using the PS/2 mouse port connection.
2. Unplug the X-Arcade™ Trackball from the computer.
3. Turn the X-Arcade™ Trackball over, laying it on a surface so that it does not touch the ball.
(example: between two books, or on your legs with the ball in between).
4. Remove the screws on the bottom of the X-Arcade™ Trackball that are recessed in the rubber feet.
Your X-Arcade™ Trackball may have small rubber covers over the screws in the center of these rubber feet, if so just pop them out.
5. Remove the bottom wooden panel. This is easiest done with a flat object like a butter knife (careful not to cut yourself) or some other wide flat object. Simply pry in between the cracks of the X-Arcade™ Trackball base and the panel, being careful not to scratch that beautiful veneer.
6. Remove the 4 bolts holding the plastic trackball housing into the wood casing.
7. With a phillips screwdriver, remove the 4 screws holding the trackball plastic casing together. Do not attempt to open the trackball plastic housing in this step.
8. Grab the bottom and top part of the plastic housing with both hands, holding them closed/together firmly, and turn it over so that the ball is facing up.
9. Remove the top half (ball side) of the plastic housing.
10. Remove the ball, and clean it with tap water and, if needed, dishwashing detergent. Dry it with a lint-free cloth.
11. Clean the rollers and idler (the 3 metal cylinders that the ball sits on) using a premoistened cleaning swab or cotton swab with rubbing alcohol. Allow surfaces to dry completely before reassembling.
12. Reassemble following the above steps backwards.

Your X-Arcade™ Trackball is cleaned, and ready for action!

A Word About Comfort and Safety

Computer User Health Information

In recent years, medical attention on occupational and recreational injuries has identified normal, seemingly harmless activities as a potential cause of a wide range of problems collectively known as Repetitive Stress Injuries (RSI) or Cumulative Trauma Disorders (CTD).

It is now recognized that any repetitive motion may contribute to these health problems. As a computer user or gamer, you might also be at risk.

The most commonly accepted causes of this type of disorder are repeated, forceful actions, usually in an awkward position or posture, without sufficient rest to allow the body to recover, especially in the presence of cold or vibration. These repetitive actions may cause tendons, ligaments, and other soft body parts to become irritated and inflamed. In addition, experts have noted that stress, both on the job and at home, can be an important contributing factor in the onset of symptoms.

By paying attention to the way you perform your work, use your computer and phone, play video games, and work around the house, you can identify the behaviors that may be putting you at risk. A thorough work site analysis by a qualified expert is important in order to reduce the risk of repetitive motion injuries. If you experience pain, swelling, numbness, or weakness in your wrists or hands (especially during sleep), see your physician immediately. These symptoms could mean that you are developing a repetitive stress injury that requires prompt medical attention. For more detailed information, consult your doctor or a reputable book.

Comfort and Safety Tips

- Place the items that you use regularly within reach. Avoid reaching and stretching.
- If you use a keyboard drawer, try to place the input device in the same tray as the keyboard. If you can't arrange this, try to place the input device nearby. Try to avoid reaching up, away, or to the side for the input device.
- Don't sit in one position for too long.
- Take breaks. Frequent short breaks are probably better than a few long ones.
- Stand up and stretch during your gaming. Try to do this frequently.
- Look into stress-reducing techniques that might work for you.
- You should not have to reach or stretch to use either the keyboard or the input device.

- When you return from a break, slightly reposition the keyboard and input device to readjust them to comfortable positions.

Furniture and posture

Arranging your office furniture is one of the most important things you can do to make your desk space comfortable:

- Adjust the height of your chair and desk so that your body is comfortably aligned.
- Stay relaxed and sit relatively upright, but don't force yourself into an unnatural position. Let your chair support you. Have your knees slightly lower than your hips, so that the angle of your torso and thighs is more than 90°.
- Support your lower back with your chair's backrest.

WARRANTY

For the most up to date warranty information, please visit www.xgaming.com

Lifetime Warranty Terms And Conditions:

Regular wear and tear of your trackball is not covered under your lifetime warranty. Refer to cleaning procedure for directions on maintaining your X-Arcade™ Trackball.

If your X-Arcade™ is ever found defective Xgaming, Inc. will attempt to send replacement parts to your location to repair the problem as X-Arcade™ products were designed to be serviced easily like a real arcade; for anyone to easily service the buttons, switches or joysticks.

In the rare occasion your unit cannot be repaired with replacement parts, during the first 12 months after purchase, we will ship a refurbished X-Arcade™ Trackball to your location and include a pre-paid, return shipping label for you to send back the defective unit at our cost.

Customers outside of USA will be responsible for all shipping charges to our location.

12 months after purchase, if it is necessary for the X-Arcade™ to be sent in for replacement or repair,

customer will be responsible for shipping the unit back to Xgaming, Inc. — but the replacement unit will be shipped back to customer at Xgaming, Inc.®'s cost.

Please register your warranty online to activate your warranty. Lifetime Warranty is NOT TRANSFERRABLE to any third party.

All claims must be made directly to Xgaming, Inc. with a proof of purchase from your retailer or distributor. Any items without a bill of sale will not be serviced and any returns or exchanges must be accompanied by first obtaining an RMA from Xgaming, Inc.. If it is determined that the X-Arcade™ has stopped working due to misuse or accidental damage, Xgaming, Inc. will not honor this repair procedure.

NOTE: Xgaming, Inc. may deem that any and all warranty work can be done on site with customer replace-able parts replaced by customer.

Xgaming, Inc.® warrants the X-Arcade™ Controller against defect in workmanship and materials as herein:

Labor: Lifetime; if Xgaming, Inc. determines that the equipment is defective subject to the limitations of this warranty, it will be replaced with a refurbished unit at no charge for labor.

Parts: Lifetime: Xgaming, Inc. will supply, at no charge, new parts to replace defective parts, against defect subject to limitations of the warranty.

These terms are for sales made directly by Xgaming, Inc. and differ from terms you may have to adhere to from the company you purchase the product from. Only purchased made from approved resellers and distributors will be warranted. Check www.xgaming.com for a listing of these companies.

Xgaming, Inc., a Delaware Corporation, will not be held liable for any incidental or consequential damages for breach of any expressed or implied warranty of the Xgaming, Inc. X-Arcade™ controller, nor an incidental or consequential damages from the inability to use, or ability to use the controller. Under no circumstance shall Xgaming, Inc liability exceed the purchase price of the product as sold by Xgaming, Inc.. Xgaming, Inc. reserves the right to refuse to honor this warranty if any of above exceptions caused the product to no longer function correctly.